



APEX MICROELECTRONICS CO.,LTD.

T: +86 756 3333768 F: +86 756 3333029 E: info@apexmic.com

Copyright © 2018 Apex Microelectronics Co., Ltd.

Disclaimer: The information contained herein is subject to change without notice. Apex shall not be liable for technical or editorial errors or omissions contained herein. Photographed products may not always match the description. All brand names & trademarks are the properties of their respective holders and used for descriptive purposes only.



www.apexmic.com @APEXMIC

USER GUIDE



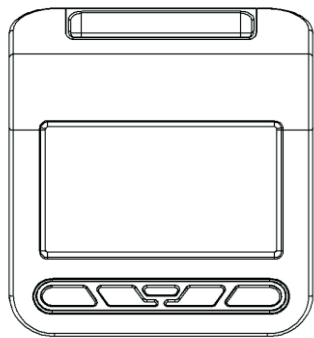

1. Unismart 3 device

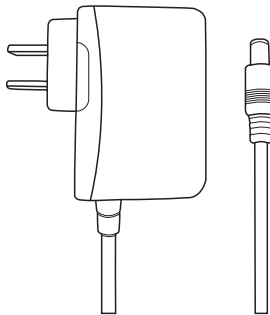

2. DC plug

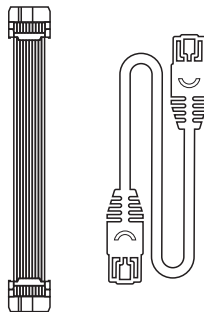

3. JIG connectors (Uni 2/Uni 3)

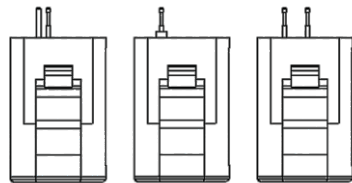

4. JIG

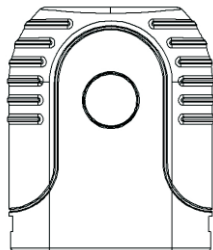

5. JIG controller

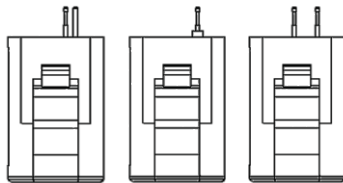

6. JIG

1. Overview

1.1 Intro of Unismart 3

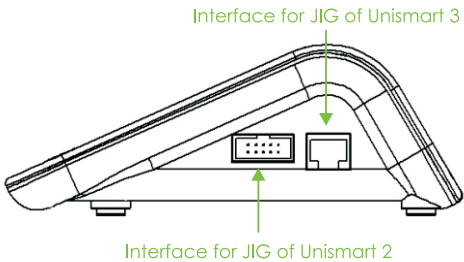
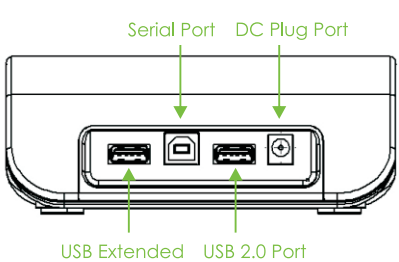

1.2 Intro of JIG

- Consist of JIGs and JIG Controller, each JIG corresponding with different chips. One JIG Controller can match up with different JIGs.
- JIGs can be replaced by pulling and plugging from the JIG Controller.

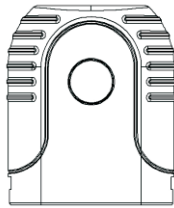

JIG controller

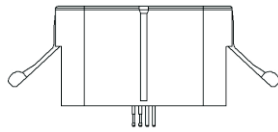

JIG

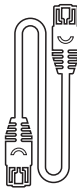

JIG connector (Uni 3)

1.2.1 JIG Instruction

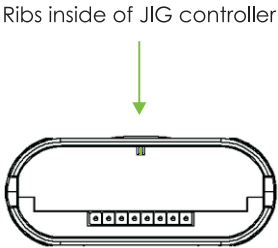
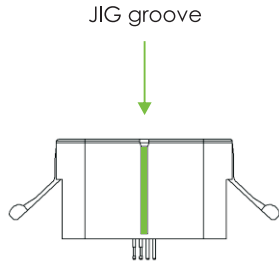

Make sure that the JIG groove is aligned with the ribs inside of JIG controller and then connect them together.

Install the JIG into JIG controller until the left and right sides of the buckle to bounce. And make sure that the buckle has been stuck with Controller's groove.

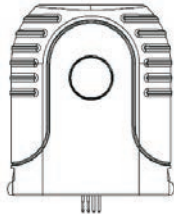
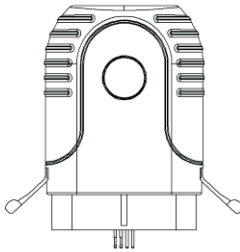

1.2.2 JIG operation tips

In the replacement of the JIG, it will be popped up by pressing the buckles on both sides of the JIG at the same time.

When pulling the JIG connection line, it is required to press the buckle until the Registered Jack is loosened.

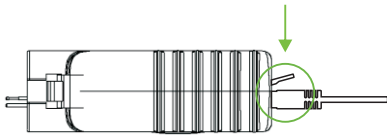

1.3 Power on/off

①As the figure shown below, connect the Unismart 3 device with the power adapter as well as the JIG.

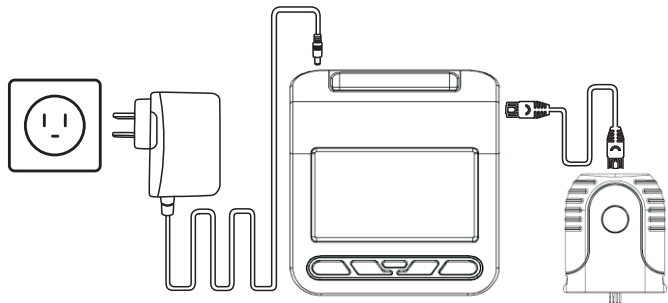

②Power on: Long press the button for 2 seconds until the indicator turn blue, the device will enter into the following interface after waiting for 20 seconds.



③Power off: Long press the button for 5 seconds until the power off prompt appears in the interface.

*Note: If the blue light keeps lighting, it means the device is still working.

2. Notices

- It is strictly forbidden to disassemble the Unismart 3 device since it will be lead to the unusable of the device. And the disassembled device should be returned to repair.
- During usage, the Unismart 3 device needs to be protected and liquid is not allowed to flow into the device. The display screen is fragile, please protect it from extrusion.
- The battery CR1220 placed in the bottom of the Unismart 3 device has a one-year working lifespan; please replace it regularly in case the abnormally display of the clock on the screen.
- Please use the power adapter supplied by Apex.
- Please do not repair or modify the device without authorization, otherwise Apex will no longer provide after-sales service.

3. Product Maintenance

- Apex offers a free 1 year warranty on Unismart 3 device (3 months warranty for screen).
- The Unismart 3 device which has quality problems appeared within 30 days can be exchanged with no charge.
- If you illegally used the Unismart 3 device and lead to the damage of the device during the warranty period, Apex will charge maintenance costs accordingly.

4. Product Specifications

Specifications		Packing List	
CPU	Dual-core 1Ghz	Unismart 3 Device	1 PCS
Screen Size	5-inch	JIG Controller	1 PCS
Resolution	800*480	JIG	6 PCS
Touch Screen	Capacitive multi-touch screen	Power Cord	1 PCS
Memory Size	DDR2 / 1GB	JIG RJ45 Connector (Uni 3)	1 PCS
Rated Power	4.5W	JIG Connector (Uni 2)	1 PCS
Power Adapter	DC15V / 1A	Position Plate	1 PCS
Support Functions	Support Wi-Fi direct connection Support connect with mouse or keyboard	Anti-static Pad	1 PCS
JIG Interface	JIG (Unismart 3): RJ45 JIG (Unismart 2): 10P socket (2*5)	CR1220 Battery	1 PCS
Device Size	140(L)*150(W)*55(H)mm	User Guide	1 PCS

Please visit www.apexmic.com and learn more details about Unismart 3.